



MetroWest+

Portishead Branch Line (MetroWest Phase 1)

TR040011

Applicant: North Somerset District Council

2.56, Important Hedgerow Plan

**The Infrastructure Planning (Applications: Prescribed Forms and Procedure) Regulations 2009, regulation 5(2)(a) and 5(2)(o)
Planning Act 2008**

Author: CH2M

Date: November 2019



Document Index

2.56	Important Hedgerow Plan	The Infrastructure Planning (Applications: Prescribed Forms and Procedure) Regulations 2009, regulation 5(2)(a) and 5(2)(o)	674946-006-020-A Rev ES-A
------	-------------------------	---	---------------------------

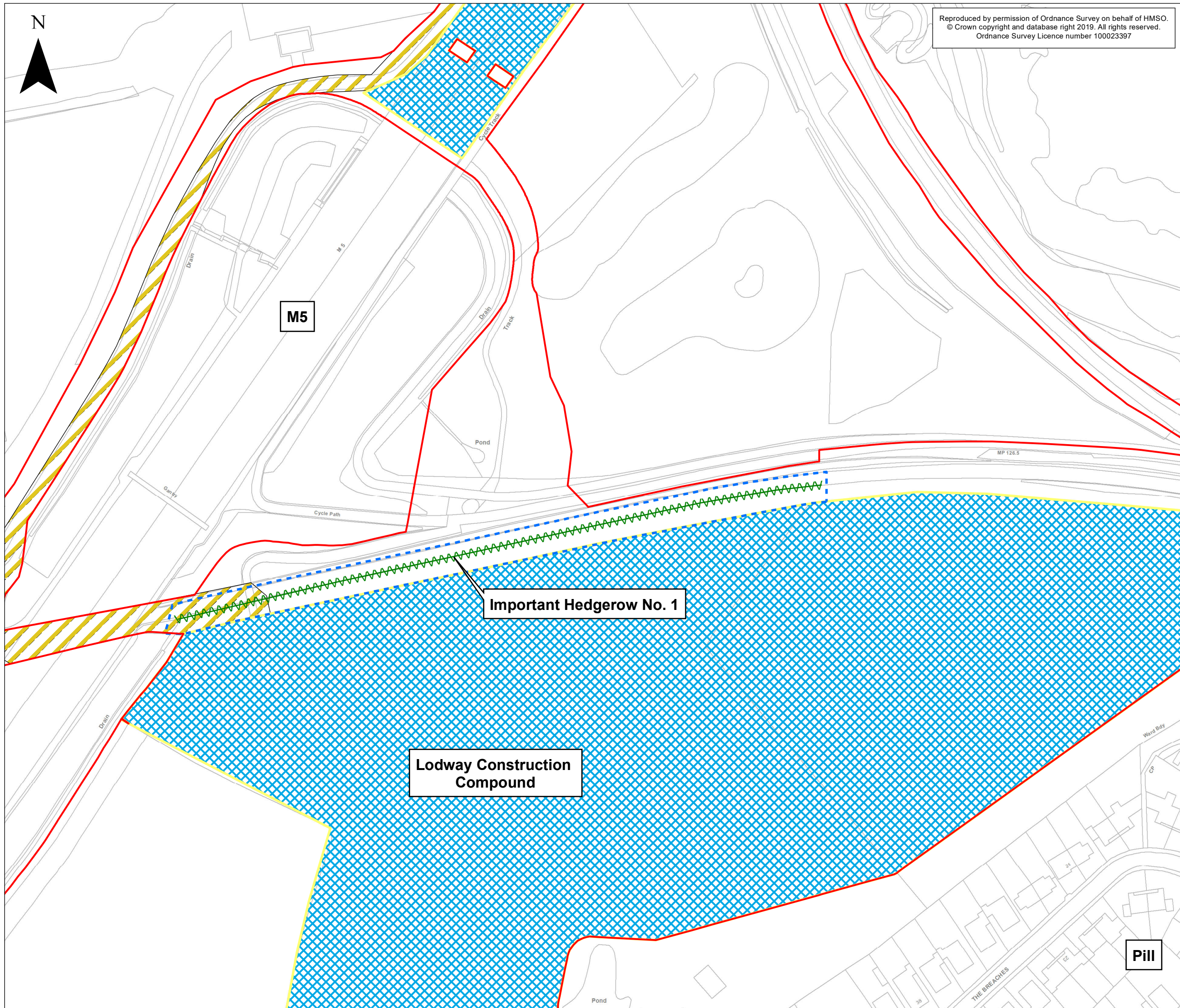

Reproduced by permission of Ordnance Survey on behalf of HMSO.
 © Crown copyright and database right 2019. All rights reserved.
 Ordnance Survey Licence number 100023397

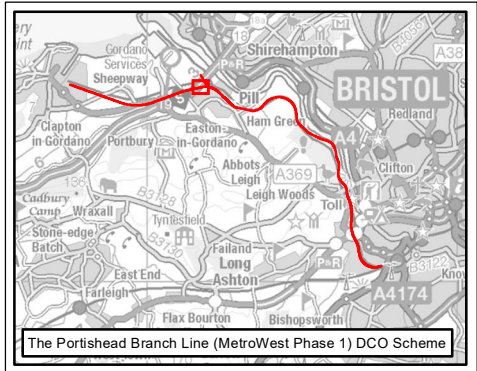

- KEY**
- Temporary Construction Compounds
 - Phase 1 Hedgerow Survey**
 - Hedgerow Survey Boundary
 - J2.1.1, Intact hedge - native species-rich
 - Portishead Branch Line**
 - Order Limits
 - Haul Road

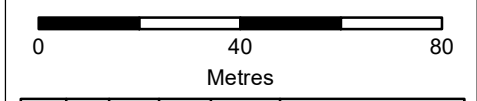

Rev	By	Chkd	Apprvd	Date	Description
ES-A	MPC	CW	CF	07/10/2019	First draft

Client

travelwest
Bath & North East Somerset, Bristol, North Somerset and South Gloucestershire Councils working together to improve your local transport

CH2M HILL
 Geospatial
 Burderop Park, Swindon, SN4 0QD
 Tel: +44 (0)1793 812479 Fax: +44 (0)1793 812089
 www.ch2m.com

Project : Portishead Branch Line (MetroWest Phase 1)

Drawing : Important Hedgerow Plan
 APFP Regulation 5(2)(a) and 5(2)(o)

Drawn By : Martin Costello Date: 07/10/2019
 Checked By : Clare Williams Date: 07/10/2019
 Approved By : Carolyn Francis Date: 07/10/2019

Drawing No. : 674946 -006-020-A Revision ES-A

Drawing Scale : 1:1,500 @ A3